

Apartment 4, 7a Claremont Chambers, Claremont Hill, Shrewsbury, SY1 1RD
£700 Per Month



Apartment 4, 7a Claremont Chambers, Claremont Hill, Shrewsbury, SY1 1RD

£700 Per Month

VIRTUAL TOUR AVAILABLE: A well-presented one bedroom second floor apartment occupying a fantastic position within the heart of Shrewsbury town centre, a stone's throw from the Quarry Park, a range of bars and restaurants and main shopping thorough fares.

Available: 09/01/2026

Description

Comprising: Lovely open plan living/dining room opening to kitchen, fitted kitchen with integrated appliances and gloss fronted units, bathroom with P-shaped bath and shower over, good sized double bedroom with views of the town centre, double glazed windows and gas fired central heating. EPC C.



Part furnished

Council Tax Band: B

Available: 9th January 2026

EPC: C

Floor Plans

Second Floor

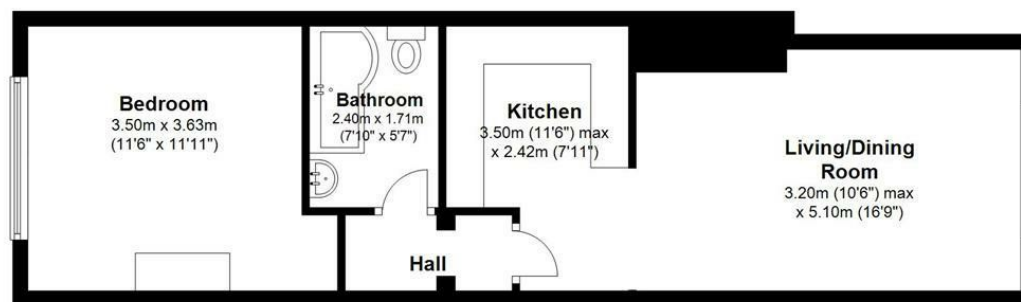

We accept no responsibility for any mistake or inaccuracy contained within the floorplan. The floorplan is provided as a guide only and should be taken as an illustration only. The measurements, contents and positioning are approximations only and provided as a guidance tool and not an exact replication of the property.
Plan produced using PlanUp.

These particulars, whilst believed to be accurate are set out as a general outline only for guidance and do not constitute any part of an offer or contract. Intending purchasers should not rely on them as statements of representation of fact, but must satisfy themselves by inspection or otherwise as to their accuracy. No person in this firm's employment has the authority to make or give any representation or warranty in respect of the property.